



## Honiton Gardens, Mill Hill, NW7 1GF

£360,000 - Leasehold

**\*\*CHAIN FREE\*\*** A 2 bedroom apartment situated on the ground floor of this modern purpose built block within the ever popular Lidbury Square development. The property features a 14ft South facing reception room with Juliet balcony and further benefits include a built-in wardrobe to the master bedroom, communal gardens easily accessed to the rear and an allocated parking space. The flat is extremely well located for Mill Hill East Tube station, a Virgin Active gym and a Waitrose supermarket and would make an ideal first time purchase.

Lease: Approx. 973 years  
Ground Rent: £216 per annum  
Service Charge: Approx. £3323 per annum

- Purpose built
- 2 bedrooms
- Off street parking
- Close to Tube
- Ideal first time purchase
- Chain free
- Long lease
- Communal gardens
- Gas central heating
- Barnet council tax band E

## Floor Plan

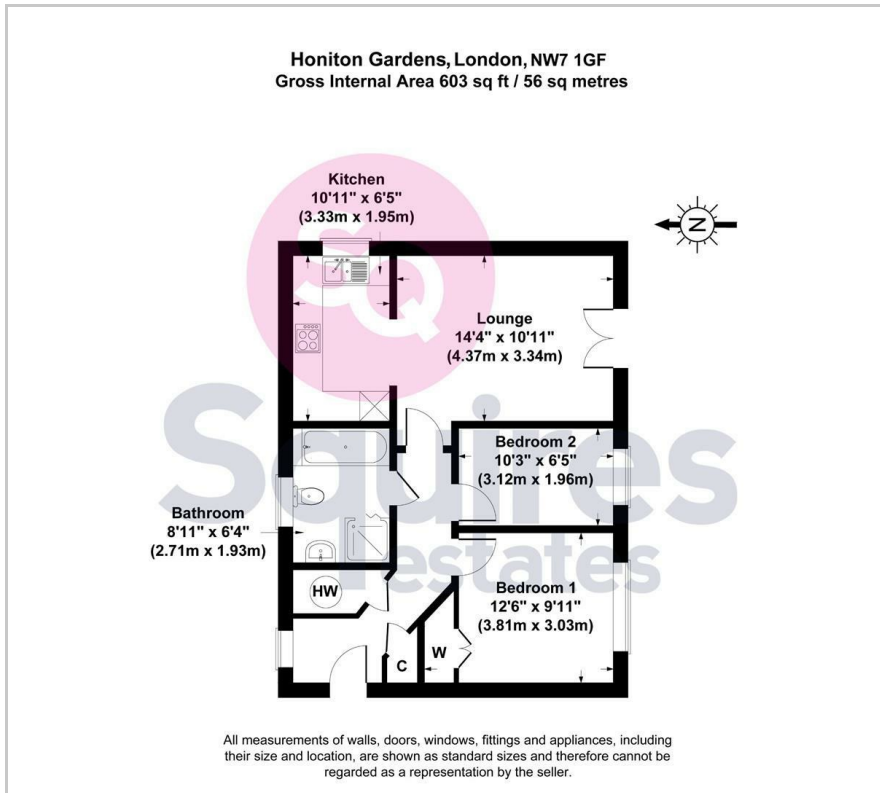

## Area Map

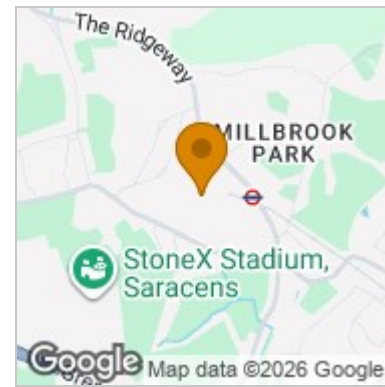

## Energy Efficiency Graph

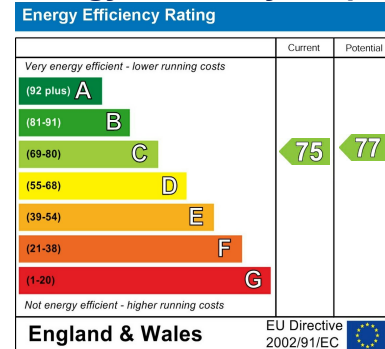

These particulars, whilst believed to be accurate are set out as a general outline only for guidance and do not constitute any part of an offer or contract. Intending purchasers should not rely on them as statements of representation of fact, but must satisfy themselves by inspection or otherwise as to their accuracy. No person in this firm's employment has the authority to make or give any representation or warranty in respect of the property.

### Finchley Branch

181a Squires Lane,  
Finchley,  
London N3 2QS  
Tel 020 8343 2111

### Hendon Branch

16 Central Circus Parade,  
Queens Road, Hendon,  
London NW4 3AS  
Tel 020 8202 0808

### Mill Hill Branch

7 Thornfield Parade,  
Holders Hill Road, Mill Hill,  
London NW7 1LN  
Tel 020 8349 3030

